

EL-WR-610A

610 cu ft Indoor Walk-In Refrigerator with Aluminum Floor and Top Mounted Refrigeration

Walk-In Unit

Dimension 8' x 10' x 7.5' ft / 96 x 120 x 91 inch (WxDxH)

Door

30" or 36" x 76" ; Solid Swing type

Door is flush type, bearing the UL seal of approval.

Door shall be equipped with two adjustable spring-assisted hinges, deadbolt locking handle with safety inside release, magnetic gasket, door closer, and a double sweep wiper at the bottom edge of the door.

Door jamb shall be provided with a LED light fixture center mounted, digital thermometer with safety pilot light on-off switch and conduit between switch box and outlet junction box

Heated pressure relief vent mounted on the door jamb for a frost free positive seal

For safe use an easy-grip, glow-in-the-dark safety release is included inside the unit to prevent accidental entrapment.



Spring Assisted Hinges



Door Closer



Keyed Locking Door Handle

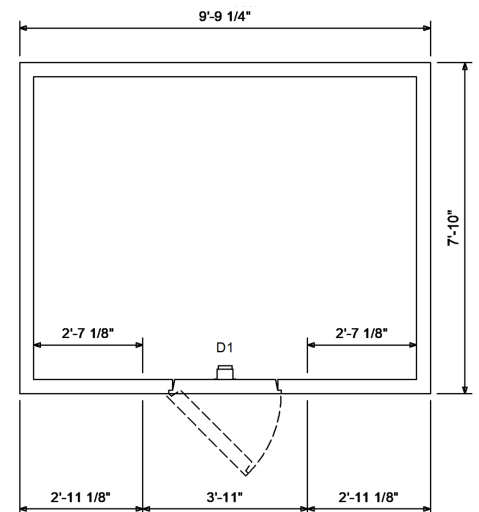

Panel 26-gauge Acrylume coated steel; Stucco embossed coated with corrosion resistant acrylic paint

Floor Aluminum floor can carry up to 600 lb/sq ft
 $\frac{1}{2}$ " radius cove along the interior perimeter for easy cleaning

ELECTRICAL

Phase Single

frequency 60 Hz

Voltage 208-230V

Light Interior - Vapor proof LED lighting



REFRIGERATION

Cooling unit The condensing unit uses a combination of microchannel coils, energy efficient compressors, and dual speed EC motors for optimal performance and efficiency

Compressor 20" height

Capacity 607 cuft

Compressor Location Top mounted

BTU/hour 7,800 BTU



UL Listed

This item has been tested and meets safety standards imposed by the Underwriters Laboratories (UL).

Refrigerant Type R 448A

Temperature 35F

PHYSICAL

Net weight (lb) 1580

Dimension See diagram

OPTIONS

Exterior Ramp

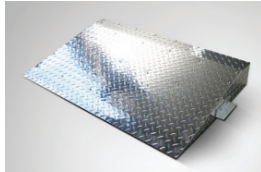

Strip Curtain



24/7 Monitoring Cloud-based continuous monitoring.



Approvals

New York City approval MEA113-87-M

City of Houston Fabrication Certificate No. 694

Department of Energy (DOE) compliance and certified, 6/2017

Miami-Dade County, Outdoor Hurricane High Velocity Wind (170 mph) NOA #17-0802.12 -
State of Florida, Outdoor Hurricane High Velocity Wind (170 mph) #FL 22413

Oregon State Component Insignia Compliance No. M-PFC 688

National Sanitation Foundation (NSF), Standard No. 7
